

FOR SALE



39 XL #019 UK DISPLAY MODEL SPECIFICATION & PRICE LIST

 **FJORD 39 XL**

TECHNICAL DETAILS

according to ISO 8666

LOA	11.97 m	39' 3"
Hull length	11.58 m	38' 0"
Beam	3.87 m	12' 8"
Draft max	1.11 m	3' 8"
Water tank	200 l	44 UK gal
Fuel tank	1140 l	251 UK gal
Displacement	8.93 t	8.79 UK t
CE Category	B	B
Max. persons	12	12

Engines
2x Volvo Penta D6-440 42 Kn*



Model year 2025

*All performance figures are given in good faith and are intended as an indication. These figures cannot be guaranteed as top speed in particular is affected by the cleanliness of the hull, conditions of the propellers, weight carried and air/sea temperature. Performance is related also to the optional accessories selected. TBC stands for To Be Confirmed after seatrial. FJORD reserves the right to change specifications in line with the company policy of improvement through research and development. Standard Propeller tested in Greifswald according to Volvo conditions. All measurements/figures approximate. Errors and omissions excepted. Specification and material can be changed without notice. Please check with your dealer for a full list of inclusions. Valid for deliveries until 2025.06.30.

ACTUAL LAYOUTS

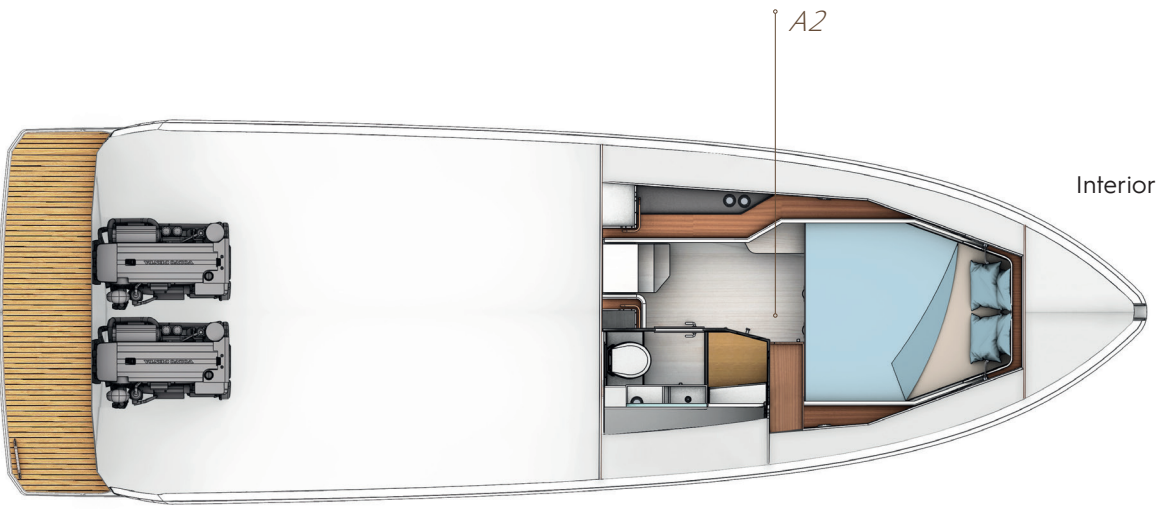
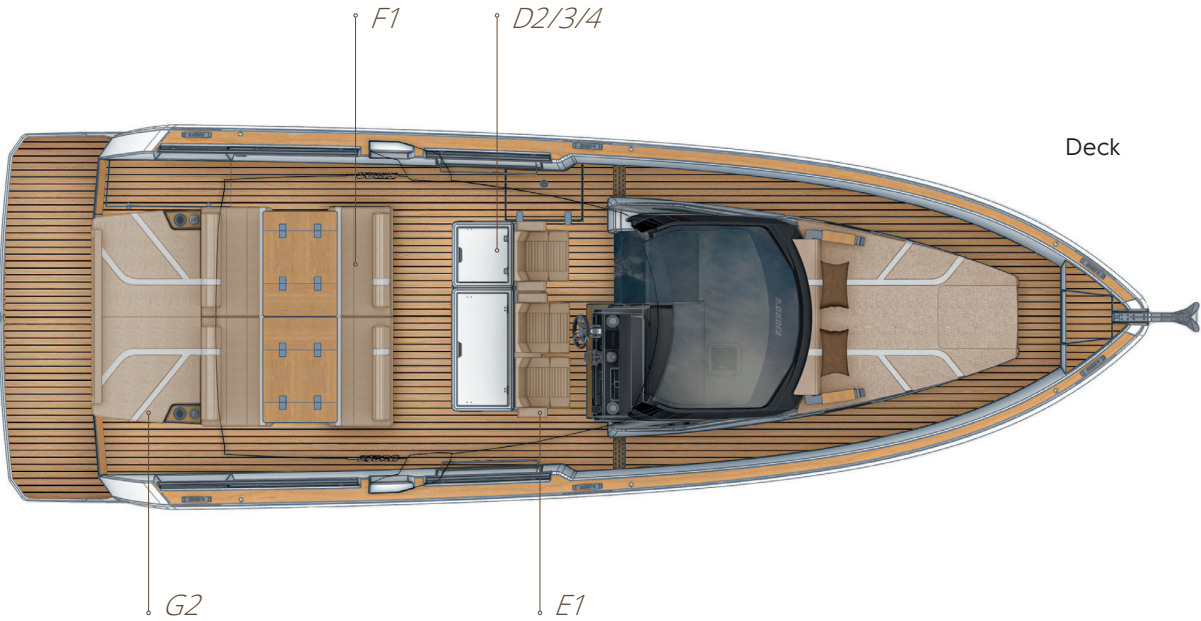
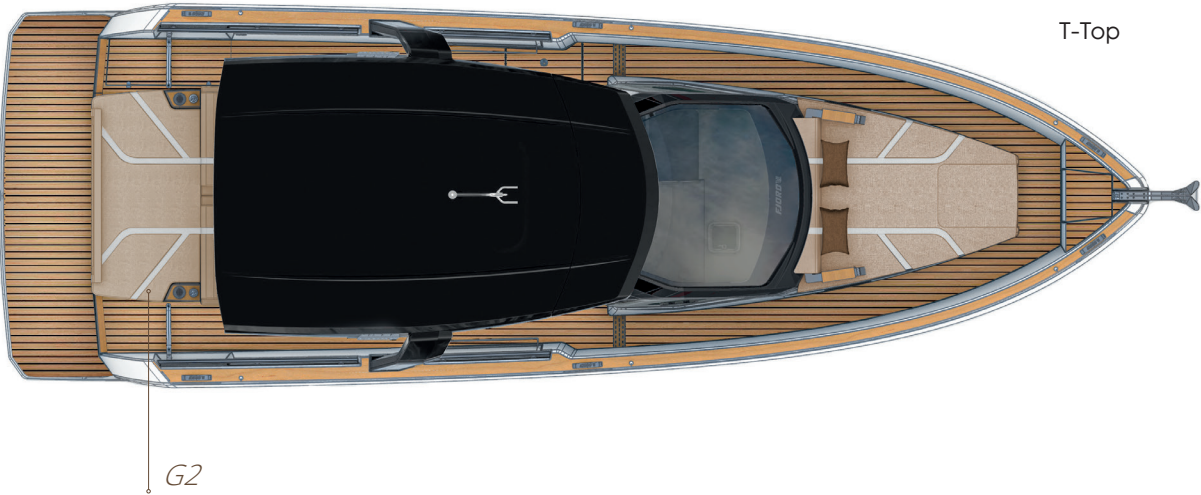



STANDARD EQUIPMENT

2025 Model Year

HULL

GRP hull, isophthalic gelcoat, colour: signal white (according to colour card), 1st layer vinyl ester resin

Waterline, isophthalic gelcoat, colour: jet black (according to colour card)

DECK & COCKPIT

Dashboard, colour: signal white (according to colour card), with foot support, handrail, switch panel and engine room fire extinguisher system

GRP deck, isophthalic gelcoat, colour: signal white (according to colour card), 1st layer vinyl ester resin. Self draining anchor locker. Anchor arm in stainless steel. Stainless steel tie bar for fender. Large diameter stainless steel handrails, gunwale in GRP. Sunpad at bow with upholstery on top.

Synthetic teak on deck and bathing platform (according to colour card)

FJORD steering wheel with tilting system

4 openable portholes (2 in cabin, 2 in toilet)

Windshield, open at the top

Bathing platform with telescopic bathing ladder, integrated in bathing platform

1 manual deck hatch in cockpit for access to engine room and 1 to technical compartment

6 aluminium mooring cleats, stainless steel handrails

Shower unit with hot and cold water

Pilot and 1 copilot seat, fixed

PROPULSION

Engine room, sound insulated, fans, fire extinguisher system, automatic and manual, Batteries-Engines: 2 x 90 Ah 12 V, Battery charger (for engine and service batteries)

2 Volvo Penta D4 (235 kW/320 hp) stern drive propeller H4, joystick, throttles, 2 Volvo 2,5" multifunctional displays

Fuel tank, capacity: 1.140 litres, fuel filter

ELECTRICAL EQUIPMENT

12 V and 230 V electric system with 230 V shore power connection. Sockets in cabin (3), toilet (1), engine room (1) and 12V on dashboard (1)

Batteries-Service: 1 x 160 Ah AGM

Country Version: EU AUS

Manual toilet

Spotlights and indirect lights in cabin and toilet. Light in engine room.

Holding tank, capacity: 60 litres

Water tank, capacity: 200 litres

Hot water boiler and pump

Bilge pumps: automatic electric (2) and manual emergency bilge pump in cockpit (1)

LAYOUT & INTERIOR

A1: Cabin with double berth, fridge and storage on p side. Fully equipped head with separated shower.

EXTERIOR MODULES

D1: Free deck

E1: Pilot and copilot seat with galley module starboard side, sink with folding mixing tap and storage, working top in marine mineral stone.

F1: 2 benches with convertible backrests and upholstery on top

G1: Free deck with wired guard rail at stern

UPHOLSTERY & WOOD

Covered mattress scheme: porto bello, colour: cream (according to colour card)

Exterior upholstery and helmsman seats - Hitch, colour: Starfish (according to colour card)

Interior furniture in high quality marine plywood, colour: warm mahogany (according to colour card)

Decor elements on p side - colour: black (according to colour card)

Fiddle on p and s side - colour: white (according to colour card)

Toilet door, vertical furniture surface on p side and front of the bed in white HPL

Ceiling in fibreglass, colour: white

Floorboard - pale acacia (according to colour card)

OTHER

Identified locations for hand held fire extinguishers - (hand held fire extinguishers are not supplied), FJORD Owner's Manual in FJORD document bag



FJORD 39 XL #019

The options highlighted show the actual specification.

€ ex VAT

Fjord 39 XL as per standard specification (ex-yard Greifswald)

459,000

PROPULSION

XC2005	2 VOLVO PENTA D6-440 (440 hp/ 324 kW) with joystick, propeller	59,800
XC5011	Volvo Penta multifunction 7" display	4,950
XC5101	Volvo Interceptor System with Auto trim, List and Coordinated Turn (only with XC5011)	11,900
XC6001	Bow thruster	4,150

PACKAGES

XW1005	COVER PACKAGE FOR E, F AND G LAYOUT	7,250
XV1004	Cover for companionway	
XV1005	Cover for dashboard	
XV1007	Cover for sunbed at bow	
XV1071	Cover for E layout	
XV1072	Cover for F layout	
XV1073	Cover for G2 layout	
XW1010	COVER PACKAGE FOR D, E, F AND G LAYOUT	7,800
XV1004	Cover for companionway	
XV1005	Cover for dashboard	
XV1007	Cover for sunbed at bow	
XV1070	1 big cover for E and D2/3/4 layout	
XV1072	Cover for F layout	
XV1073	Cover for G2 layout	
XW2000	UPHOLSTERY PACKAGE ECO	9,350
XU1005	Covered mattress - ECO	
XU1023	Exterior upholstery and helmsman seats - ECO	
XW3000	SMART CONNECTION PACKAGE	5,000
XE3110	WLAN router	
XN3800	Interior camera	
XW5000	LIGHT PACKAGE ON MAIN DECK (ONLY WITH G2 LAYOUT AND T-TOP)	5,200
XD4031	Two pop up lights at bow and two in the rear sunpad	
XD4053	Indirect light (RGBW) in T-Top, sunbed, galley and dashboard	
XW7000	ENTERTAINMENT PACKAGE (ONLY WITH XN6000)	3,450
XE2000	FUSION APOLLO MS-RA770 with AM/FM	
XE2101	2 high-end 2 way speakers inside	
XE2110	2 high-end 2 way speakers at helm position	
XE2201	FUSION MS-ERX400 remote control at helm position	
XE3001	FUSION link for connection with portable devices	



XW7001	ULTIMATE 3-ZONE EXTERIOR ENTERTAINMENT PACKAGE UPGRADE (ONLY WITH XW7000)	7,400
XE2056	2 FUSION MS-DA51600 5 channel amplifier	
XE2108	2 high-end 2-way speakers at fwd sunbed	
XE2109	2 high-end 2 way speakers at aft sunbed	
XE2120	2 high-end subwoofers in cockpit area	
XE2208	FUSION MS-ERX400 remote control on fwd sunbed	
XE2209	FUSION MS-ERX400 remote control on aft sunbed	

EXTERIOR OPTIONS

HULL		
XA1001	GRP hull, painted, non metallic	31,150
XA1002	GRP hull, painted, metallic	44,550
XA2001	Waterline, painted, non metallic	4,000
XA2002	Waterline, painted, metallic	5,550

DECK & COCKPIT		
XB1006	Dashboard, painted, non metallic	4,350
XB1007	Dashboard, painted, metallic	5,150
XB1056	Synthetic teak on deck and bathing platform	Standard
XB1055	Real teak on deck and bathing platform	11,000
XB1062	Gunwale - real teak	4,750
XB1063	Gunwale - synthetic teak	3,600
XB3000	Electric gangway/bathing ladder with steps	35,650
XB3291	Glass windshield up to the T-Top with wipers	4,550
XB3510	Bathing stairs with handle, foldable	850
XB4005	Galvanised anchor 15 kg and 50 m stainless steel chain incl. electrical windlass with automatic fuse	7,300
XB4006	Stainless steel anchor 15 kg and 50 m stainless steel chain incl. electrical windlass with automatic fuse	8,350
XB4110	Anchor chain counter at helm position	800
XB4500	2 towing plates at bow	5,100
XB9001	T-Top in GRP with spot and indirect light. Gelcoat finishing, colour: white	20,200
XB9010	T-Top painted, non metallic	13,250
XB9020	T-Top painted, metallic	15,900

EQUIPMENT OPTIONS

EQUIPMENT		
XD1002	Battery set upgrade, capacity: 2x 90 Ah + 3x 160 Ah AGM	3,150
XD1010	Battery set, Li-Io, capacity: TBC	13,150
XD1110	Deep charge protection for service batteries	1,450
XD1601	Country Version: US / JPN	4,500
XD2002	Mass Combi Pro Inverter 12/3000-150 230 V (only with XD1002 or XD1010)	4,150
XD2090	Solar panel on T-Top (only with XB9001)	8,650
XD3210	Toilet, electric	1,600
XD4001	Courtesy lights on deck	2,400
XD4011	Underwater multicolour lights (RGBW) on transom	5,100



FJORD 39 XL #019

XD4054	Interior indirect lighting (RGBW)	2,500
XD6001	Air conditioning (only with XD2002)	11,450
XD8010	Greywater Tank	2,900

NAVIGATION & INSTRUMENTS

XN1001	Simrad multifunction display NSS evo3S-12" at dashboard with DST transducer	6,700
XN1005	Simrad multifunction display NSS evo3S-16" at dashboard with DST transducer	8,900
XN1011	Additional Simrad multifunction display NSS evo3S-16" at dashboard	6,650
XN1100	Simrad IS42 multipurpose instrument (depth, speed, temperature)	1,400
XN2001	Simrad HALO20+ Radar	5,000
XN2002	Simrad HALO20+ Radar dome, painted	3,150
XN2101	Simrad VHF RS100, with VHF antenna and splitter for FM/AIS	1,400
XN3001	Simrad Autopilot with electronic compass	7,900
XN3500	Simrad NAIS500	2,400
XN3560	MyFJORD Safety Cloud hardware with 30 days free trial subscription	1,550
XN3700	Simrad Sonarhub Sounder and HDI Transducer	2,650
XN6000	VHF antenna with splitter for FM/AIS	800

INTERIOR LAYOUT & UPHOLSTERY

LAYOUT & INTERIOR

XL1001	A1: Cabin with double berth, fridge and storage on p side, heads with separate shower	Standard
XL1002	A2: Cabin with double berth, fridge, storage and wardrobe on s side, heads with separate shower	1,900

EXTERIOR MODULES

XM1000	D1: Free Deck	Standard
XM1001	D2: Galley module prt. side with storage and 1 additional copilot seat	10,900
XM1002	D3: Galley module prt. side with gas BBQ and 1 additional copilot seat	12,000
XM1003	D4: Galley module prt. side with 2 gas rings and 1 additional copilot seat	12,000
XM9000	For D2, D3 and D4: Galley module p side, painted, non metallic	5,700
XM9005	For D2, D3 and D4: Galley module p side, painted, metallic	6,500
XM7000	E1: Pilot and copilot seat with galley module stb side, sink, storage, worktop	Standard
XM8000	For E: Fridge	2,050
XM9010	For E: Galley module stb. side, painted, non metallic	7,200
XM9015	For E: Galley module stb. side, painted, metallic	8,300
XM8005	F1: 2 benches with convertible backrests and upholstery on top	Standard
XM4000	G1: Free deck with wired guard rail at stern	Standard
XM4001	G2: Sunbed with storage, 2 benches with backrest and 2 foldable tables with fixed leg	23,650
XM8010	For G2: 2 foldable tables with electrical high low leg and upholstery on top	9,400
XM8011	For G2: 2 drawer fridges under the benches	5,000

UPHOLSTERY & WOOD

XU1001	Covered mattress - smooth	1,000
XU1002	Covered mattress - dash	1,400
XU1003	Covered mattress - padua	1,700
XU1006	Covered mattress - Hitch	1,250
XU1021	Exterior upholstery and helmsman seats - Hitch	1,450



XU1022	Exterior upholstery and helmsman seats - Dolce Vita	3,550
XU1024	Exterior upholstery and helmsman seats - Classic style with stitching in Hitch	4,650
XU1025	Exterior upholstery and helmsman seats - Sport style: main surface in Hitch, stripes in Hitch	6,050
XU5001	Furniture - atlanta walnut	1,400
XU5002	Furniture - milano oak	1,850
XU5003	Furniture - lisboa chestnut	2,050
XU5005	Furniture - Horizontal surface on p side and bulkhead on s side covered	1,950
XU5111	Decor elements on p side and next to bedhead painted	450
XU5116	Fiddle and toilet decorative panel painted	1,450
XU5301	Ceiling covered in Hitch, colour: Iceberg	2,250
XU6011	Floorboard, companionway and steps - noce nero	550
XU6012	Floorboard, companionway and steps - eternal oak	900
XU6013	Floorboard, companionway and steps - basque oak	900
XU6014	Floorboard, companionway and steps - classic teak white	1,550
XU6015	Floorboard, companionway and steps - classic teak black	1,550
XU6016	Floorboard, companionway and steps - charcoal teak	1,550

ACCESSORIES & DELIVERY

ACCESSORIES

XV2002	Electric extensible bimini in the T-Top, colour: black (only with XB9001)	14,650
XV2010	Sun awning, fwd, manual (only with XB9001)	4,150
XV5001	6 cushion fenders	1,400

SHIPPING AND TRANSPORT

XZ2001	Loading on truck with disassembled deck parts and antennas	800
XZ2010	Oversea shipping cradle	4,150
XX000	Transport from Germany to UK (other destinations available)	14,400

COMMISSIONING

IMG001	Hull preparation, prime & antifouling; outdrive antifouling	6,250
IMG002	Commissioning, PDI, Warranty Activation, Full Valet & Handover	9,250

TOTAL BOAT PRICE AS SPECIFIED - EX VAT		€ 765,850
UK VAT - 20%		€ 153,170
GRAND TOTAL - INC UK VAT		€ 919,020

The above specification is representative of the actual boat available as she currently is specified and is limited to one available unit.

Please discuss with us if there are options of relevance and interest that are not currently installed as retrofit is possible with most options.

Commissioning & Delivery is shown as Hamble, UK on which UK VAT would chargeable. Export deliveries outside of the UK are possible and therefore VAT may be due in the country of delivery. Please talk to us about your preferred home boating location and if there are reliefs from VAT available (such as EU Temporary Admission).

The available unit can only be secured with a fully signed contract and a 30% deposit.

Delivery can be immediate or delayed with prior agreement and can be based in sterling or euros as required.

 **FJORD 39** XL

BE UNIQUE





 **FJORD 39** XL

ESCAPE THE ORDINARY





INSPIRATION

— MARINE GROUP —

Head Office: Southampton, UK +44 (0) 2380 457008

European Partner Offices

info@fjordboats.co.uk www.fjordboats.co.uk